

# Dolphin PROX2 GYRO Pool Cleaner

## Operating Instructions



### **Rainbow Pool Products**

PO Box 2388, Mansfield Qld 4122

Telephone STD 61-7-3849 5385

Facsimile STD 61-7-3849 5384

Email: [info@rainbowpoolproducts.com.au](mailto:info@rainbowpoolproducts.com.au)

Web: [www.rainbowpoolproducts.com.au](http://www.rainbowpoolproducts.com.au)



# Dolphin PROX 2 Gyro Robotic Pool Cleaner

## Operating Instructions

### Contents

- 1. INTRODUCTION .....3
- 2. SPECIFICATIONS .....3
- 3. WARNINGS AND CAUTIONS.....3
  - 3.1. Warnings.....3
  - 3.2. Cautions.....3
- 4. POOL CLEANER PARTS.....4
- 5. USING THE POOL CLEANER.....5
  - 5.1. Setup.....5
  - 5.2. Putting the Pool Cleaner into the pool.....6
  - 5.3. Removing the Pool Cleaner from the pool.....6
  - 5.4. Maintenance.....7
  - 5.5. Off season storage.....8
- 6. POWER SUPPLY .....9
- 7. REMOTE CONTROL UNIT.....10

# Dolphin PROX 2 Gyro Pool Cleaner

## Operating Instructions

### 1. INTRODUCTION

Thank you for purchasing a Maytronics Robotic Pool Cleaner.

We are sure that your Maytronics Robotic Pool Cleaner will provide you with reliable, convenient and cost effective pool cleaning. Its reliable filtration in all pool conditions and all-surface climbing brush enhance maximum pool hygiene.

The Robotic Pool Cleaners by Maytronics deliver advanced cleaning technologies, long lasting performance and easy maintenance.

### 2. SPECIFICATIONS

Motor protection: IP 68

Minimum depth: 0.80m/2.6ft

Maximum depth: 5m/16.4ft

### 3. WARNINGS AND CAUTIONS

#### 3.1. Warnings



- Use the originally supplied power supply only
- Ensure the electrical outlet is protected by a ground fault interrupter (GFI) or an earth leakage interrupter (ELI)
- Keep the power supply out of standing water
- Position the power supply at least 3m/10ft away from the edge of the pool
- Do not enter the pool while the pool cleaner is working
- Unplug the power supply before servicing

#### 3.2. Cautions

When not in use store the Pool Cleaner on the Caddy in a shaded area.

Use the Pool Cleaner in the following water conditions only:

|             |                    |
|-------------|--------------------|
| Chlorine    | Max 4 ppm          |
| pH          | 7.0 - 7.8          |
| Temperature | 6 – 34°C (43-93°F) |
| NaCl        | Maximum = 5000 ppm |

## 4. POOL CLEANER PARTS

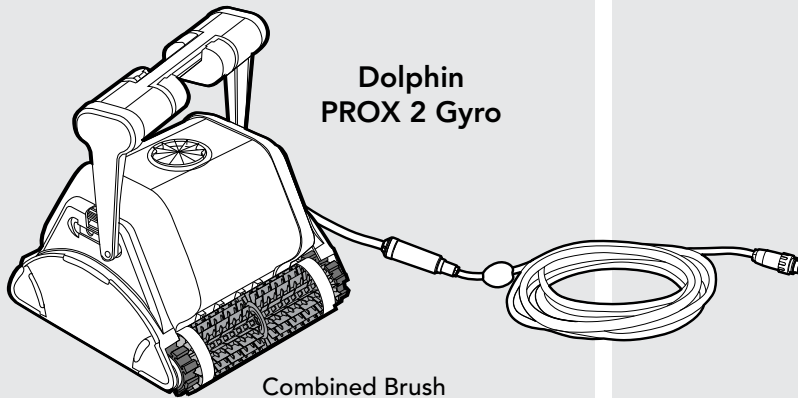

**Dolphin  
PROX 2 Gyro**

**Combined Brush**  
For rough ceramics.  
Surface and mosaic tiles.

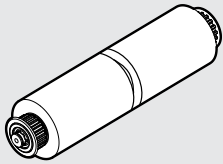

**Wonder Brush**  
For smooth ceramics.  
(optional)

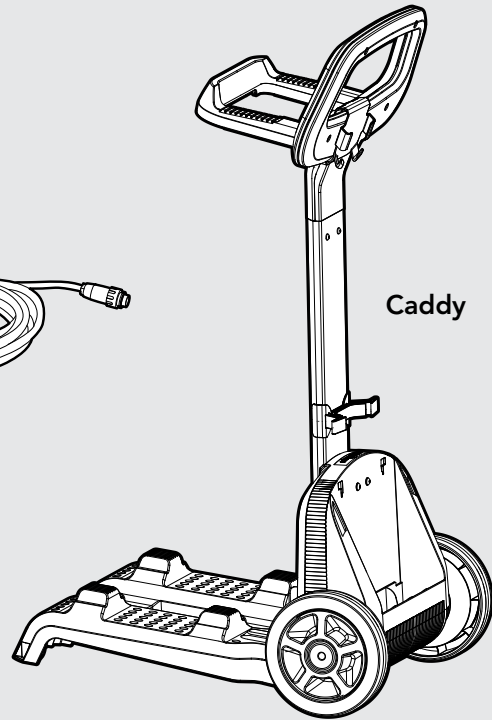

**Caddy**

**Bottom lid and filter Bag**

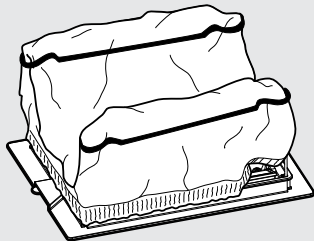

**Filter bag options:**  
Fine - default  
Ultra fine - extra



**Remote Control Unit**

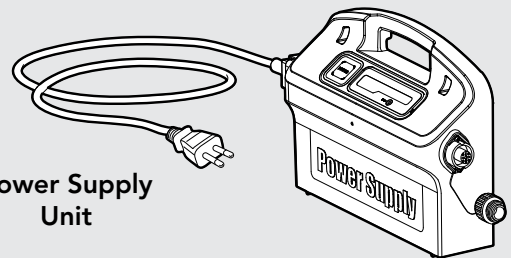

**Power Supply  
Unit**

## 5. USING THE POOL CLEANER

### 5.1. Set Up

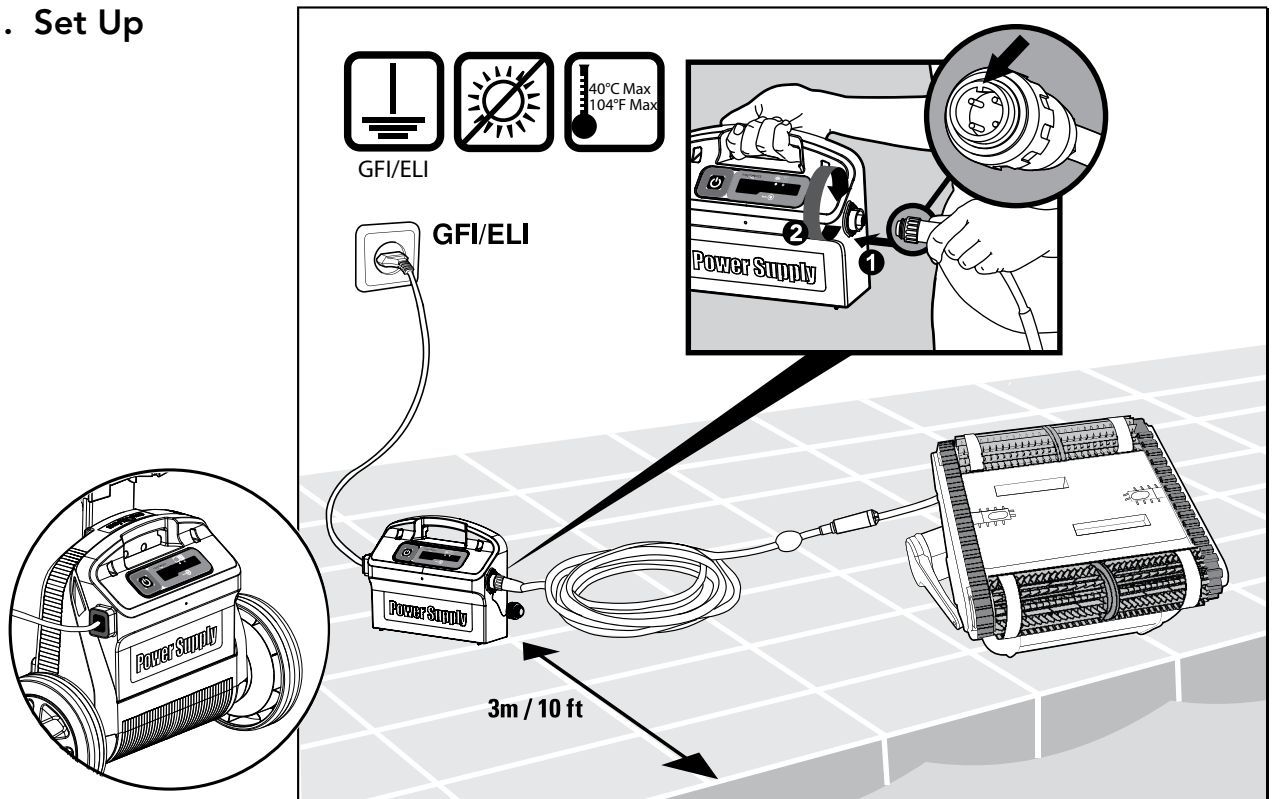

Change diagonal handle position for water line sideways movement.

To adjust the handle angle:

- A. Press the latch down and hold it in position.
- B. Move the handle to the desired position and release the latch to hold the handle in place.

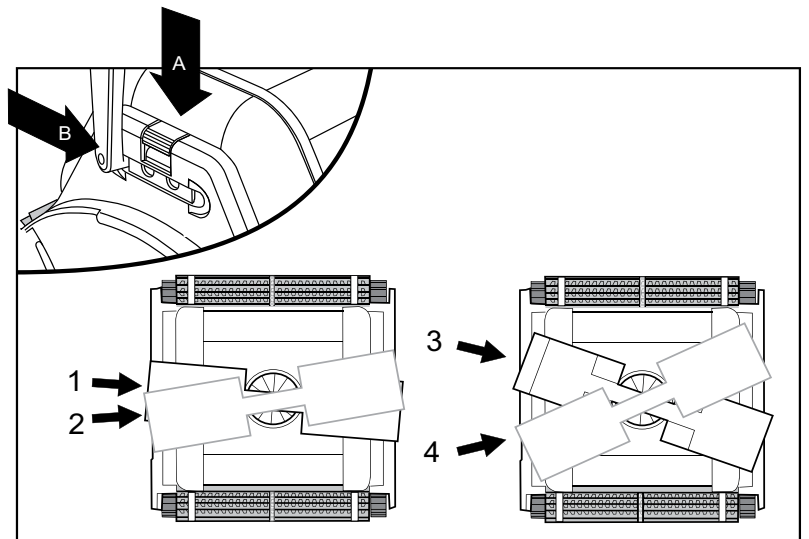

## 5.2. Putting the Pool Cleaner into the pool

If Wonder brush/ Wonder rings are dry, soak them in water until soft.

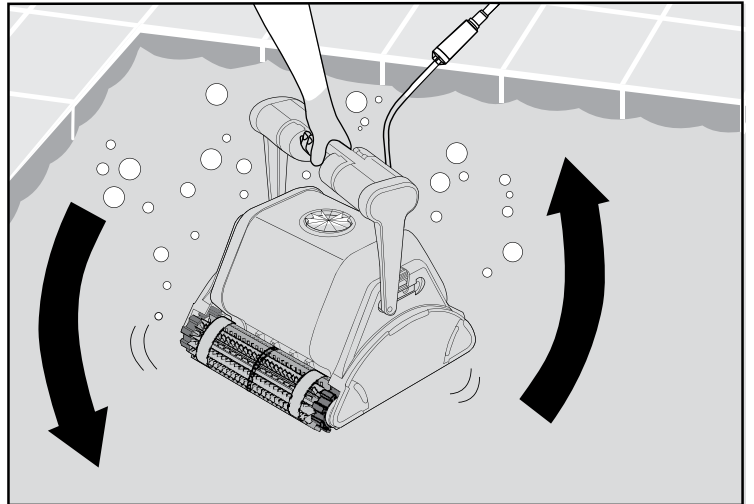

Turn the power supply ON

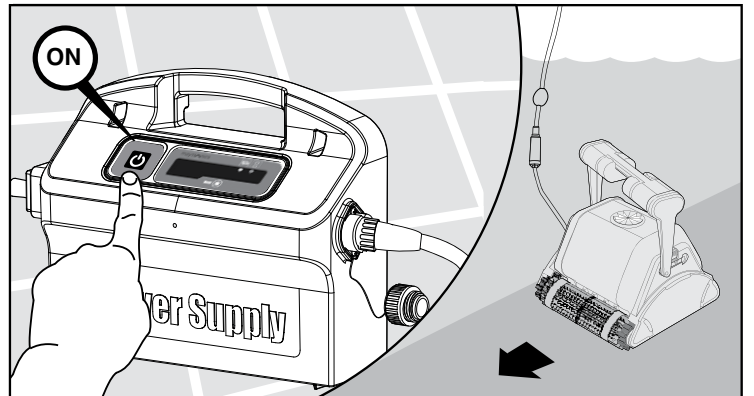

## 5.3. Removing the Pool Cleaner from the pool

The robot will perform automatic shut-off at the end of the cleaning cycle.

 Turn OFF and unplug the power supply

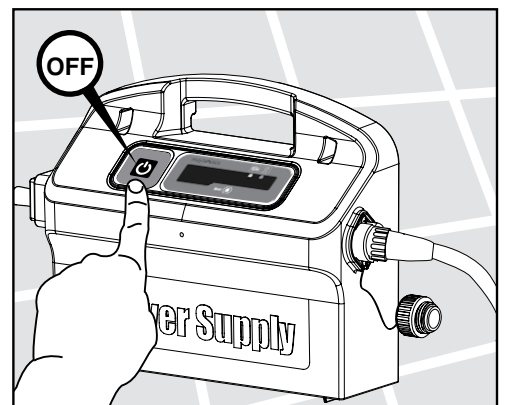

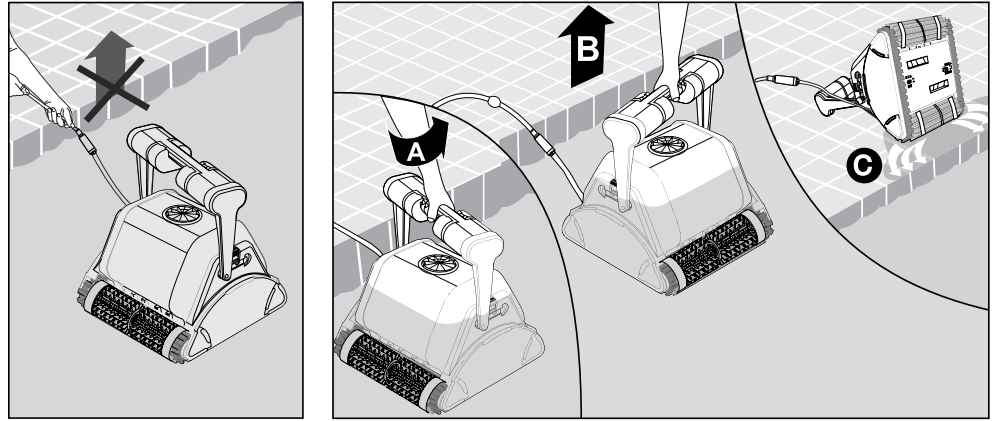

Using the floating cable, bring the Pool Cleaner to the pool's edge.

**!** DO NOT PULL THE POOL CLEANER FROM THE POOL USING THE CABLE

### 5.4. Maintenance

Clean the filter bag with a hose.  
 Periodically clean the brushes with a hose.  
 It is recommended to periodically wash the filter bag in a washing machine.  
 Use gentle cycle program.

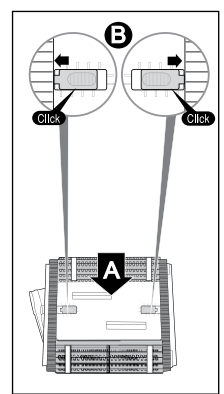
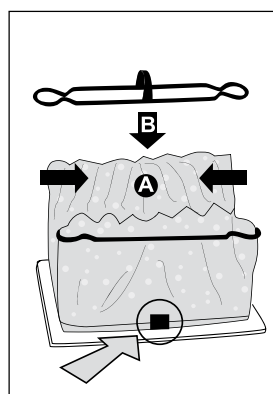
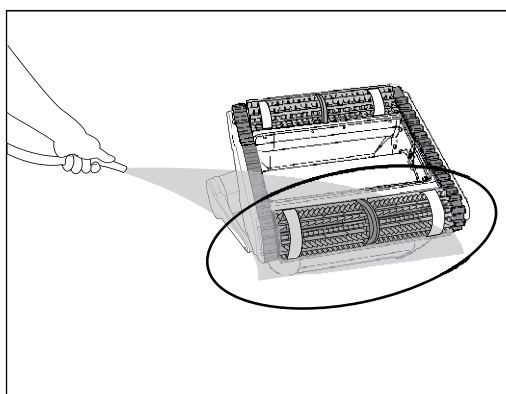
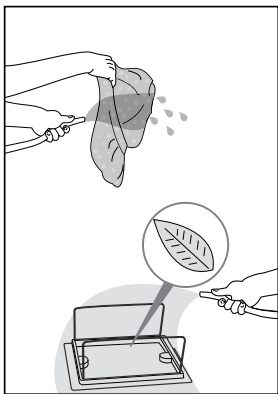
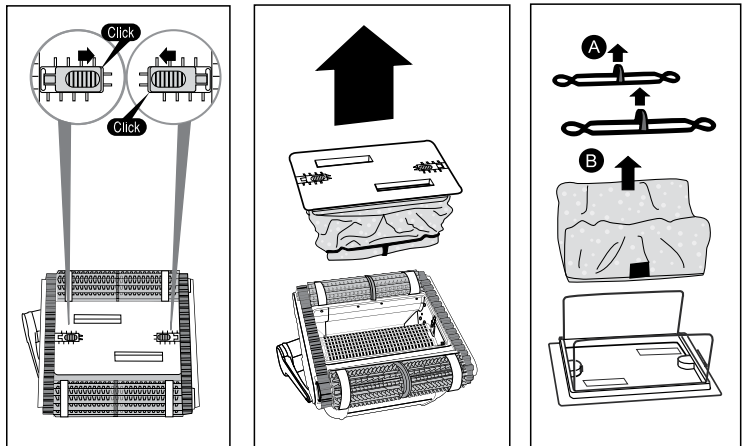

## Cleaning the impeller

 **Unplug the power supply**

If you notice debris trapped in the impeller open the impeller and remove the debris.

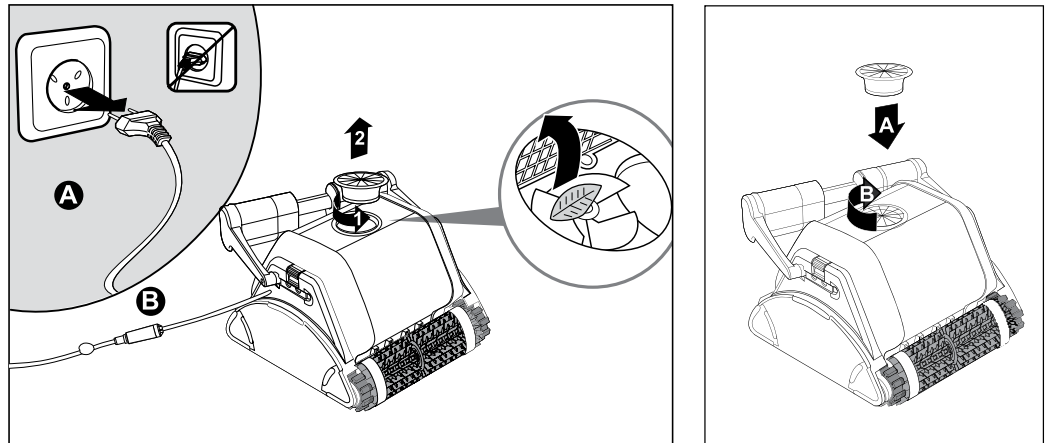

## Cable

To remove the kinks, stretch the cable out completely and let it sit for at least a day in the sun.

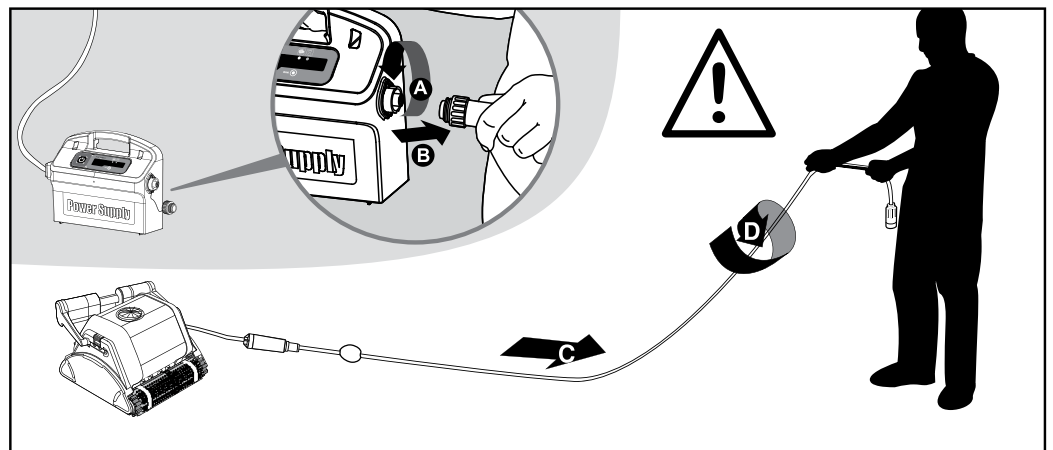

## 5.5. Off season storage

If the pool cleaner will not be in use for an extended period, perform the following storage steps:

- Make sure that no water is left in the pool cleaner.
- Thoroughly clean the filter bag and insert in place.
- Roll up the cable so that it has no kinks and place on the Caddy.
- Store the pool cleaner in a protected area either on its Caddy or simply upsidedown.

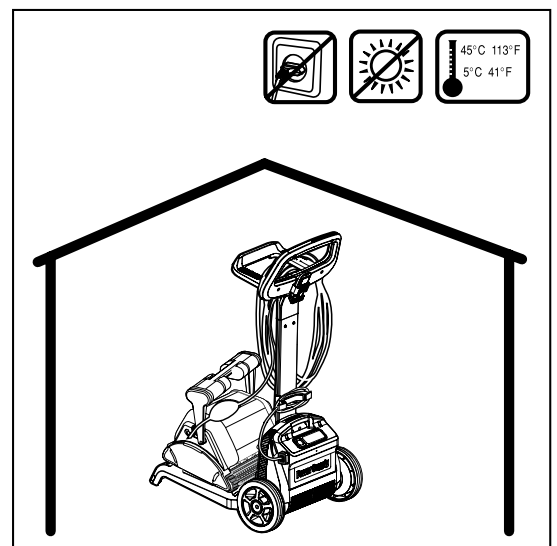



## 6. POWER SUPPLY

Digital "Switch-Mode" Power Supply with full filter bag and delay indicator.

- Input - 100-250 AC Volts
- 50-60 Hertz
- 180 Watt
- Output - <30 VDC
- IP 54

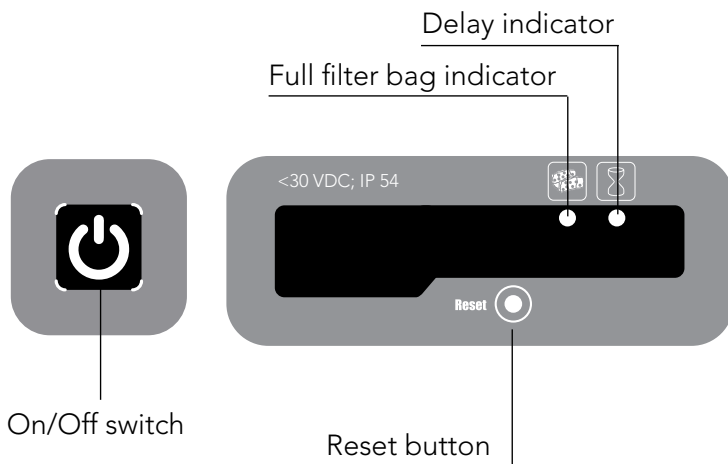
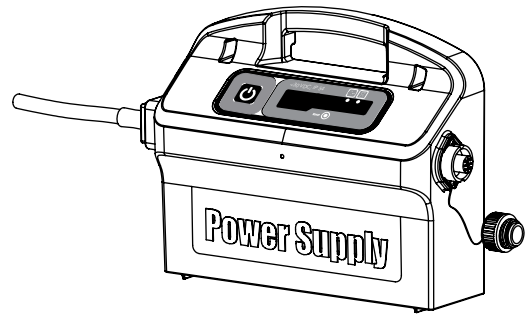

### Full filter bag indicator and Reset button

The power supply is equipped with a filter bag status indicator.

The red LED indicates two filter conditions.

- When blinking - The filter is partially blocked.
- When lighted - The filter is blocked and must be emptied and cleaned.

If the LED does not turn off after the filter bag had been emptied and cleaned, press the RESET button while the robot is working.



### Delay indicator

The power supply is equipped with a Delay indicator that indicates if the Delay option is activated (through the remote control unit).

## 7. REMOTE CONTROL UNIT

### The Control Panel

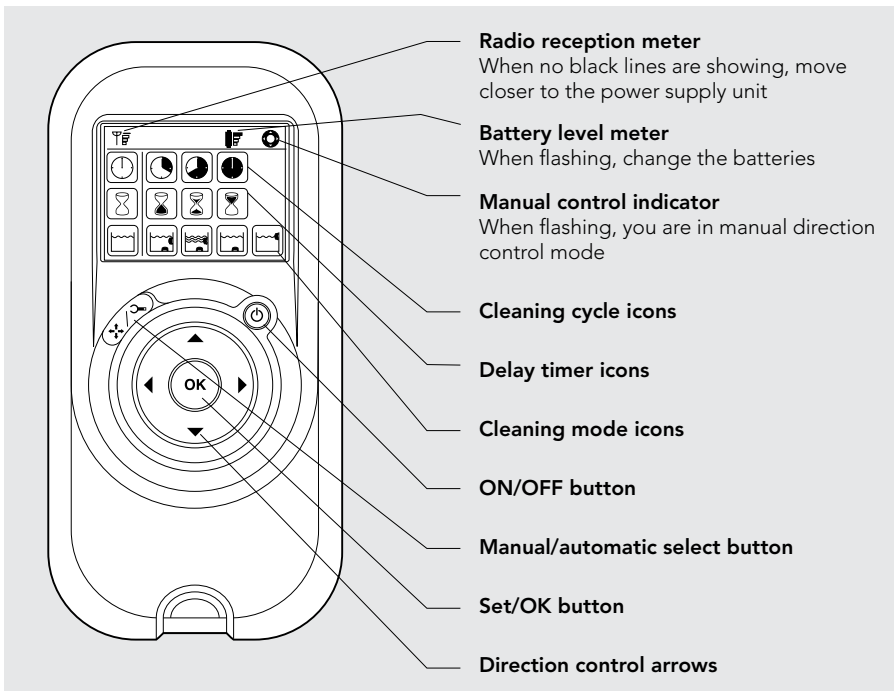



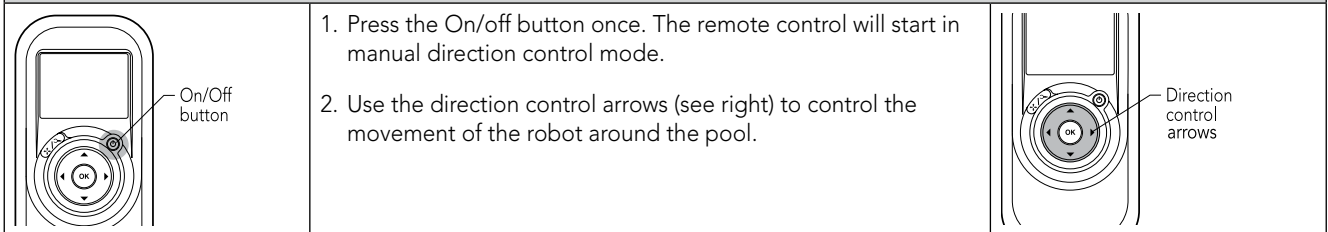



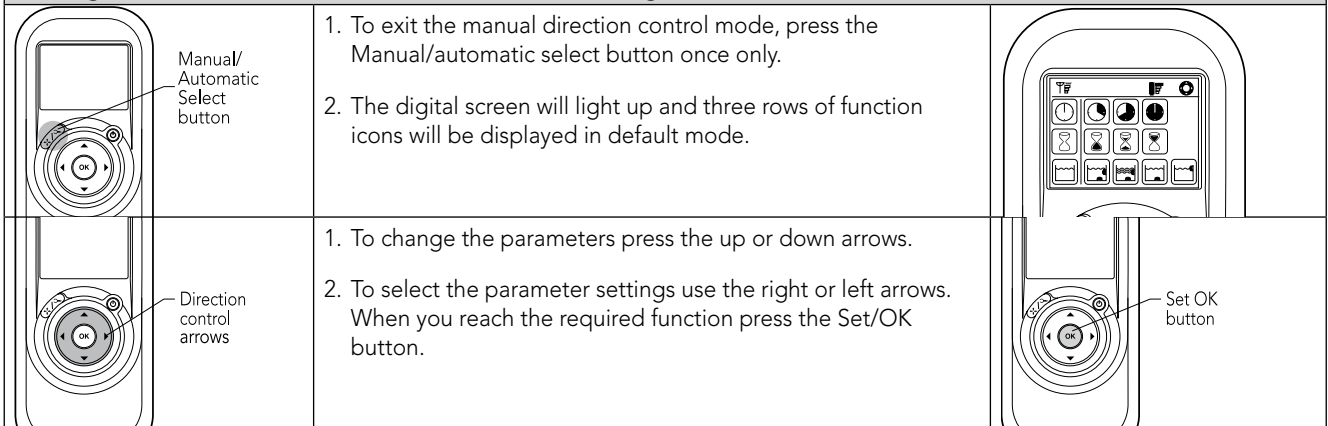



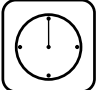

#### Manual Direction Control Mode



#### Exiting Manual Direction Control Mode and setting the Automatic Mode

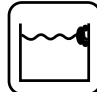

Press the manual/automatic select button and then choose the desired parameters according to the following table:

|  |  |   |   |   |
|--|--|---|---|---|
|  <p><b>Cleaning cycle indicator</b><br/>This determines the length of the cleaning cycle.</p>   |  <p><b>Fast</b><br/>4-hour cycle</p>                                    |  <p><b>Efficient</b><br/>6-hour cycle for everyday use. (Default setting)</p>          |  <p><b>Extra</b><br/>8-hour cycle</p>  |   |
|  <p><b>Delay time indicator</b><br/>This determines when the pool cleaner starts to work. Delaying allows the dirt to settle to the bottom of the pool.</p> |  <p><b>Immediate start</b><br/>(Default setting)</p>                    |  <p><b>One-hour delay</b></p>  |  <p><b>Two-hour delay</b></p>  |   |
|  <p><b>Cleaning action indicator</b><br/>Allowing you to choose from the following options.</p>  |  <p><b>Standard</b><br/>Floor and wall cleaning. (Default setting)</p> |  <p><b>Ultra-clean</b><br/>Stronger suction and slower movement. (floor and wall)</p> |  <p><b>Floor only</b><br/>Cleans only the floor and the area where the floor and walls meet</p> |  <p><b>Walls only</b><br/>Cleans walls and waterline only</p> |

**Note:**

- After 2 minute if no button is pressed, the Remote Control Unit will shut-down and the Pool cleaner will continue to work in the previous settings.
- When the "Ultra-Clean" and "Walls Only" options finish their cycles, the Pool Cleaner will return to default settings.