

MX GAS HEATER 2000-2011

Key	Description	Product Code	Qty Required
1	CORNER POST - FRONT RIGHT - MX	100308	1
2	SIDE PANEL - LOWER - INLET/OUTLET	100311	1
3	SIDE PANEL - UPPER - INLET/OUTLET	100310	1
4	REAR PANEL - MX 125	101305	1
	REAR PANEL - MX 150	151305	1
	REAR PANEL - MX 200	201305	1
	REAR PANEL - MX 250	251305	1
	REAR PANEL - MX 300	301305	1
	REAR PANEL - MX 400	401305	1
	REAR PANEL - MX 500	501305	1
5	TOP PANEL / LID - MX 125	101306	1
	TOP PANEL / LID - MX 150	151306	1
	TOP PANEL / LID - MX 200	201306	1
	TOP PANEL / LID - MX 250	251306	1
	TOP PANEL / LID - MX 300	301306	1
	TOP PANEL / LID - MX 400	401306	1
	TOP PANEL / LID - MX 500	501306	1

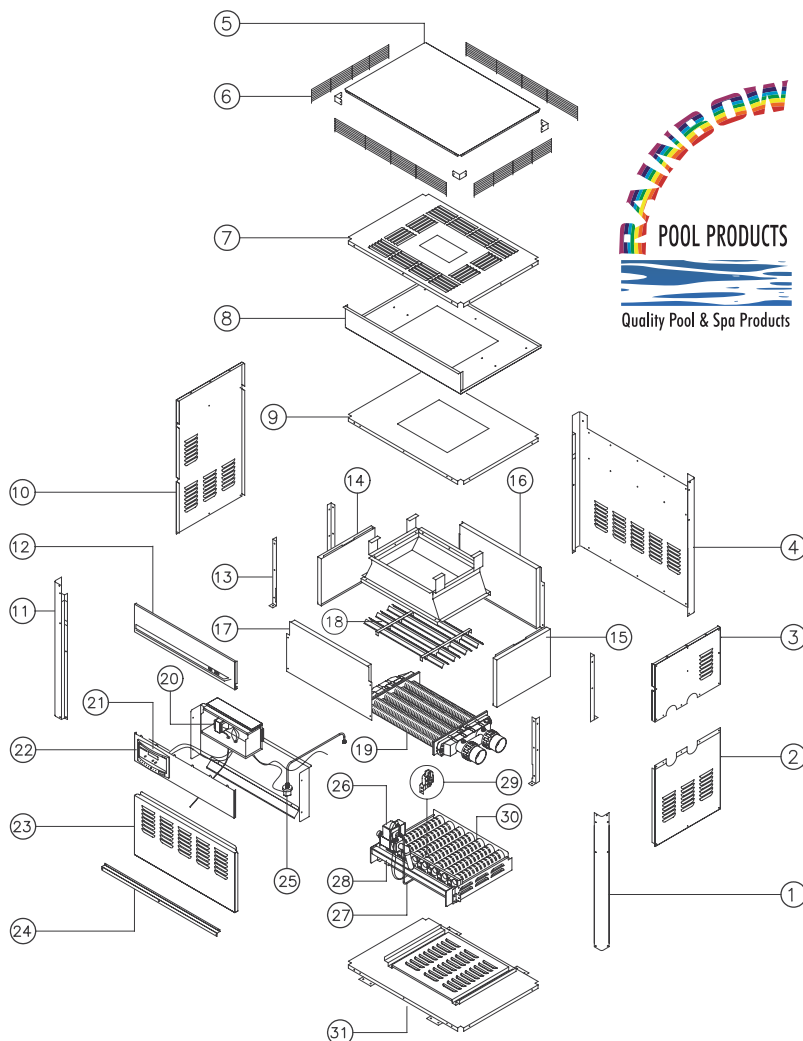

Rainbow Pool Products

PO Box 2388, Mansfield Qld 4122

Telephone STD 61-7-3849 5385

Facsimile STD 61-7-3849 5384

Email: info@rainbowpoolproducts.com.au

Web: www.rainbowpoolproducts.com.au

MX GAS HEATER 2000-2011

Key	Description	Product Code	Qty Required
7	FLUE TERMINAL - MX 125	101304	1
	FLUE TERMINAL - MX 150	151304	1
	FLUE TERMINAL - MX 200	201304	1
	FLUE TERMINAL - MX 250	251304	1
	FLUE TERMINAL - MX 300	301304	1
	FLUE TERMINAL - MX 400	401304	1
	FLUE TERMINAL - MX 500	501304	1
8	FLUE BAFFLE - INSULATION - MX 125	101104	1
	FLUE BAFFLE - INSULATION - MX 150	151104	1
	FLUE BAFFLE - INSULATION - MX 200	201104	1
	FLUE BAFFLE - INSULATION - MX 250	251104	1
	FLUE BAFFLE - INSULATION - MX 300	301104	1
	FLUE BAFFLE - INSULATION - MX 400	401104	1
	FLUE BAFFLE - INSULATION - MX 500	501104	1
9	FLUE BAFFLE - SEPARATOR - MX 125	101107	1
	FLUE BAFFLE - SEPARATOR - MX 150	151107	1
	FLUE BAFFLE - SEPARATOR - MX 200	201107	1
	FLUE BAFFLE - SEPARATOR - MX 250	251107	1
	FLUE BAFFLE - SEPARATOR - MX 300	301107	1
	FLUE BAFFLE - SEPARATOR - MX 400	401107	1
	FLUE BAFFLE - SEPARATOR - MX 500	501107	1
10	SIDE PANEL - MX HEATER	100309	1
11	CORNER POST - FRONT LEFT	100307	1
12	FRONT FACIA PANEL- UPPER - MX 125	101302	1
	FRONT FACIA PANEL- UPPER - MX 150	151302	1
	FRONT FACIA PANEL- UPPER - MX/HM/H	201302	1
	FRONT FACIA PANEL- UPPER - MX/HM/H	251302	1
	FRONT FACIA PANEL- UPPER - MX/HM/H	301302	1
	FRONT FACIA PANEL- UPPER - MX/HM/H	401302	1
	FRONT FACIA PANEL- UPPER - MX/HM/H	501302	1
13	SUPPORT LEG -FIRE BOX - MX HEATER	100118	Set of 4
14	SIDE - FIRE BOX WITH INSULATION	72200	1
15	SIDE - FIRE BOX WITH INSULATION	72200	1
16	REAR FIRE BOX WITH INSULATION MX125	72212	1
	REAR FIRE BOX WITH INSULATION MX150	72214	1
	REAR FIRE BOX WITH INSULATION MX200	72202	1
	REAR FIRE BOX WITH INSULATION MX250	72204	1
	REAR FIRE BOX WITH INSULATION MX300	72206	1
	REAR FIRE BOX WITH INSULATION MX400	72208	1
	REAR FIRE BOX WITH INSULATION MX500	72209	1

MX GAS HEATER 2000-2011

Key	Description	Product Code	Qty Required
17	FRONT FIRE BOX WITH INSULATION MX125	72211	1
	FRONT FIRE BOX WITH INSULATION MX100	72213	1
	FRONT FIRE BOX WITH INSULATION MX200	72201	1
	FRONT FIRE BOX WITH INSULATION MX250	72203	1
	FRONT FIRE BOX WITH INSULATION MX300	72205	1
	FRONT FIRE BOX WITH INSULATION MX400	72207	1
	FRONT FIRE BOX WITH INSULATION MX500	72210	1
18	BAFFLE HEAT EXCHANGER - MX 125	100125	Set
	BAFFLE HEAT EXCHANGER - MX 150	150125	Set
	BAFFLE HEAT EXCHANGER - MX 200	200125	Set
	BAFFLE HEAT EXCHANGER - MX 250	250125	Set
	BAFFLE HEAT EXCHANGER - MX 300	300125	Set
	BAFFLE HEAT EXCHANGER - MX 400	400125	Set
	BAFFLE HEAT EXCHANGER - MX 500	500125	Set
19	Heat Exchange - MX125 Complete	78410	1
	Heat Exchange - MX150 Complete	78411	1
	Heat Exchange - MX200 - Complete	78412	1
	Heat Exchange - MX250 Complete	78413	1
	Heat Exchange - MX300 Complete	78414	1
	Heat Exchange - MX400 Complete	78415	1
	Heat Exchange - MX 500 Complete	78416	1
20	TRANSFORMER - 240V/24V - 1.75AMP	70275A	1
21	PCB - THERMOSTAT	70280	1
21A	SENSOR LEAD - ELECTRONIC THERMOSTAT	70276	1
22	CONTROL PANEL - MX 125	101200	1
	CONTROL PANEL - MX 150	151200	1
	CONTROL PANEL - MX 200	201200	1
	CONTROL PANEL - MX 250	251200	1
	CONTROL PANEL - MX 300	301200	1
	CONTROL PANEL - MX 400	401200	1
	CONTROL PANEL - MX 500	501200	1
23	FRONT DOOR PANEL - MX 125	101300	1
	FRONT DOOR PANEL - MX 150	151300	1
	FRONT DOOR PANEL - MX 200	201300	1
	FRONT DOOR PANEL - MX 250	251300	1
	FRONT DOOR PANEL - MX 300	301300	1
	FRONT DOOR PANEL - MX 400	401300	1
	FRONT DOOR PANEL - MX 500	501300	1

MX GAS HEATER 2000-2011

Key	Description	Product Code	Qty Required
24	DOOR RAIL STRIP - MX 125	101301	1
	DOOR RAIL STRIP - MX 150	151301A	1
	DOOR RAIL STRIP - MX 200	201301	1
	DOOR RAIL STRIP - MX 250	251301	1
	DOOR RAIL STRIP - MX 300	301301	1
	DOOR RAIL STRIP - MX 400	401301	1
	DOOR RAIL STRIP - MX 500	501301	1
25	PRESSURE SWITCH WITH UNION	71580	1
26	SMART GAS VALVE - MX/HM/HB 200-4	73733	1
	SMART GAS VALVE - MX/HM/HB 500	73735	1
	IGNITION MODULE	73754	1
27	PILOT TUBE - MX HEATER	70310	1
28	BURNER RAIL - MX125	70266	1
	BURNER RAIL - MX150	70267	1
	BURNER RAIL - MX200	70261	1
	BURNER RAIL - MX250	70262	1
	BURNER RAIL - MX300	70263	1
	BURNER RAIL - MX400	70264	1
	BURNER RAIL - MX500	70265	1
29	PILOT ASSEMBLY - SMART VALVE	73734	1
	PILOT ASSEMBLY - LH TIP	71511	1
30	GAS BURNER TUBE - 50mj	70996	1
31	BASE ASSEMBLY - SPOTWELDED - MX 120	101400	1
	BASE ASSEMBLY - SPOTWELDED - MX 150	151400	1
	BASE ASSEMBLY - SPOTWELDED - MX 200	201400	1
	BASE ASSEMBLY - SPOTWELDED - MX 250	251400	1
	BASE ASSEMBLY - SPOTWELDED - MX 300	301400	1
	BASE ASSEMBLY - SPOTWELDED - MX 400	401400	1
	BASE ASSEMBLY - SPOTWELDED - MX 500	501400	1
not shown	HI LIMIT - 70deg C - INCLUDES BRASE	71018H	1
not shown	BRASS PLUG - HI LIMIT - MX HEATER	71050	1
not shown	WIRING LOOM - MX 125-400	65012	1
not shown	WIRING LOOM - MX 500	65016	1
not shown	LEAD & 3 PIN PLUG - 3 MTR	350025	1
not shown	COOLING FAN SENSOR MX 200-500	71012	1
not shown	FLAME SENSING ROD	70011	1
HI LIMITS			
	HI LIMIT - 45° C - NC AUTO THREAD	71030	1
	HI LIMIT - 55° C - NC AUTO THREAD	71031	1
	HI LIMIT - 70° C - NC AUTO THREAD	71032	1
	HI LIMIT - 100° C-NC MANUAL THREAD	71033	1
	BRASS PLUG - TAPPED M4 3/8	71053	1

MX GAS HEATER 2000-2011

Key	Description	Product Code	Qty Required
4	BOLT - SHORT - 3/8" UNC X 1-3/4"	40147	4
5	BOLT - LONG - 3/8" UNC X 3-1/4"	40148	6
5A	WASHER - 3/8" X 25MM- MUDGUARD	40149	10
6	Baffle Return Header MX Heater	71003	1
7	HEAT EXCHANGER CUPRO NICKEL MX 125	73595	1
	HEAT EXCHANGER CUPRO NICKEL MX 150	73596	1
	HEAT EXCHANGER - CUPRO NICKEL	73600C	1
	HEAT EXCHANGER - CUPRO NICKEL	73601C	1
	HEAT EXCHANGER - CUPRO NICKEL	73602C	1
	HEAT EXCHANGER - CUPRO NICKEL	73603C	1
	HEAT EXCHANGER CUPRO NICKEL MX/HB	73597	1
10	DISC - BY-PASS ASSEMBLY	76026	1
11	SPRING - BY-PASS ASSEMBLY	71922	1
12	O RING - BY-PASS ASSEMBLY	70007	1
13	PLUNGER - BY PASS ASSEMBLY	76025	1
14	LOCK NUT UNION - 50MM	950919	2
15	TAIL UNION - 50MM ABS	950920	2
16	O RING - 50MM UNION	70003	2
17	THERMOSTAT WELL - 1/8" BRASS	477165	1
18	HI LIMIT - 45deg C	71018	1
19	BRACKET RETAINER - HI LIMIT - MX	100206	1
20	GASKET - TUBE SEAL	76120	18
21	BRASS PLUG - HI LIMIT - MX HEATER	71050	2
not shown	IN/OUT MANIFOLD - COMPLETE - MX125	71024	1
not shown	IN/OUT MANIFOLD - COMPLETE - MX200	71025	1
not shown	MANIFOLD - RETURN - COMPLETE - MX 200-500	71028	1

