

# FLUXJET 2V

2.2 kW; 2.2 Kw LHT (50Hz)

2.55 kW; 2.55 Kw LHT (60Hz)

The standard side channel blowers/aspirators are designed to handle clean air up to a maximum of 40°C. Please contact us for special applications.

Motors construction conform with CEI 2-3 (1988) NORMS. ISOL. CL F PROT. IP 55, cCSAus certified

cCSAus file nr. 242079 

	Articolo	kW	V	Hz	assorb. AMP	giri/min.	limite servizio	dB (A)*	peso (Kg)
	Item code				absorbed AMPS	r.p.m.	max cont. duty S1 (mbar)		weight (Kg)
TRIFASE THREE-PHASE	048150	2.2	230 Δ 400 Y	50	9 Δ 5.2 Y	2850	-230 +265	72	31
	048150	2.55	265 Δ 460 Y	60	9 Δ 5.2 Y	3450	-260 +245	72	31
	048161 LHT	2.2	230 Δ 400 Y	50	9 Δ 5.2 Y	2850	-265 +265	72	31
	048161 LHT	2.55	265 Δ 460 Y	60	9 Δ 5.2 Y	3450	-280 +245	72	31

\* Livello di pressione sonora rilevato secondo le Norme ISO 3746 - 1979 (E). Parametri: r=1 - Rumore di fondo 51 dB (A) - Strumento: Brüel & Kjær type 2232.

\* Sound pressure level tested according to ISO regulation 3746 - 1979 (E). Parameters: r=1 - Background noise 51 dB (A) - Instrument: Brüel & Kjær type 2232.

dimensions:

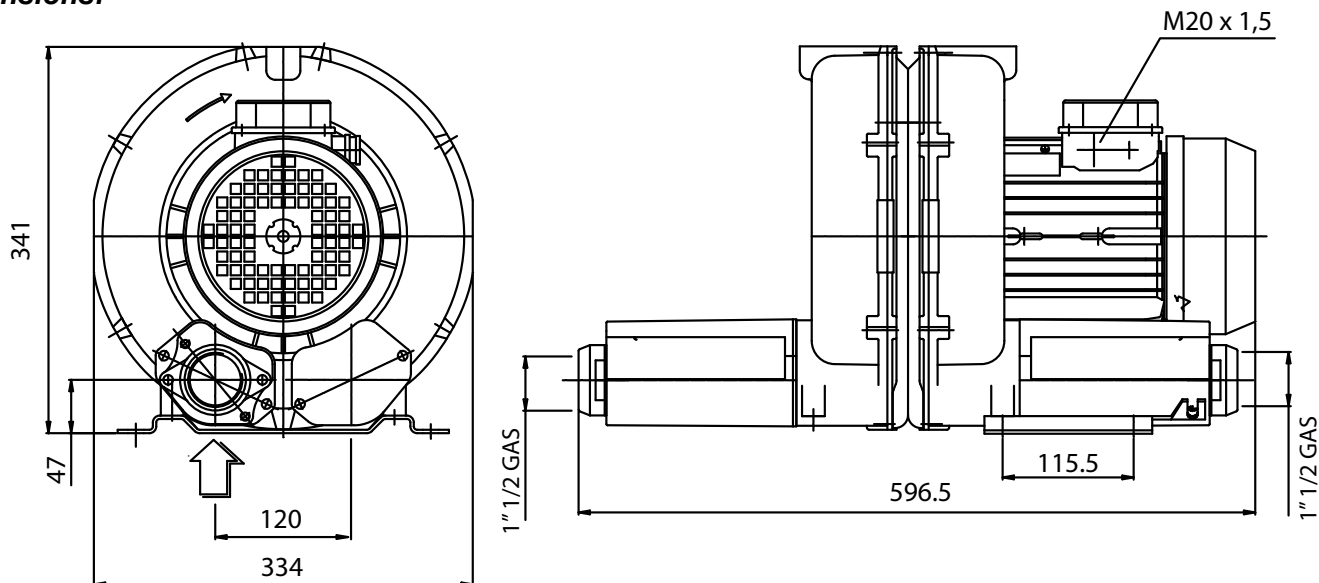

all dimensions are in mm

## VACUUM

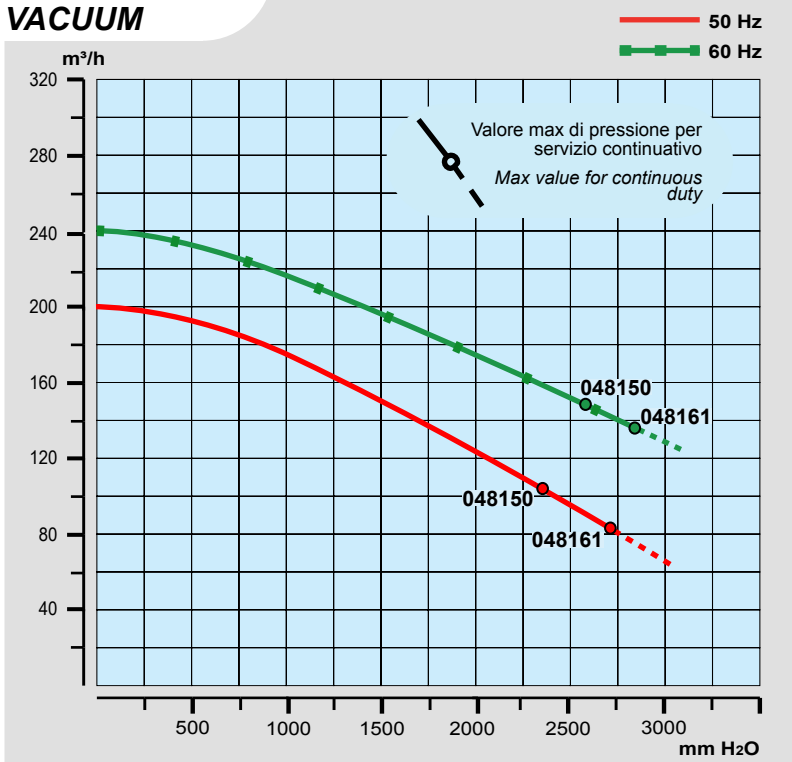

## MOTOR ABSORPTION

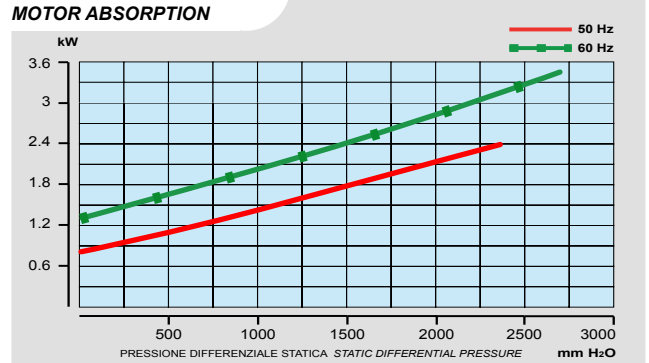

## AIR TEMPERATURE INCREASE

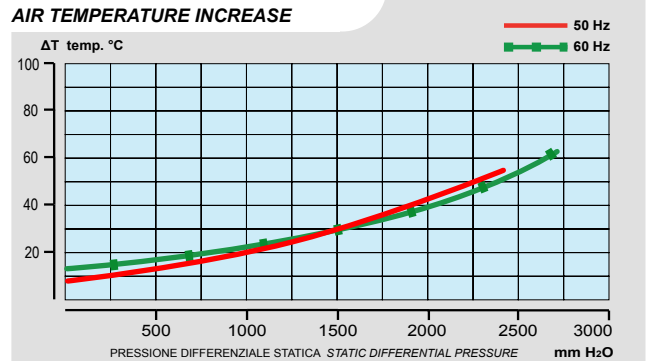

## PRESSURE

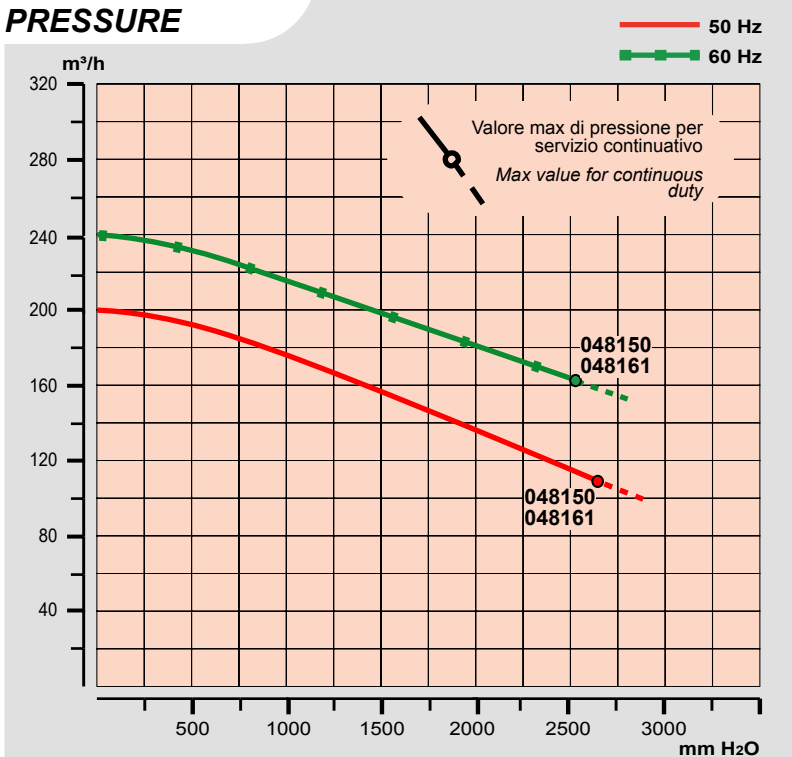

## MOTOR ABSORPTION

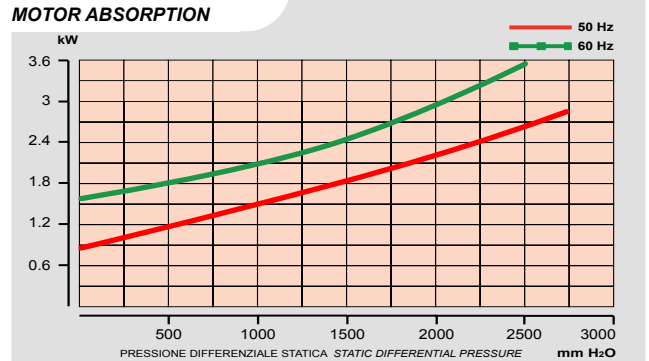

## AIR TEMPERATURE INCREASE

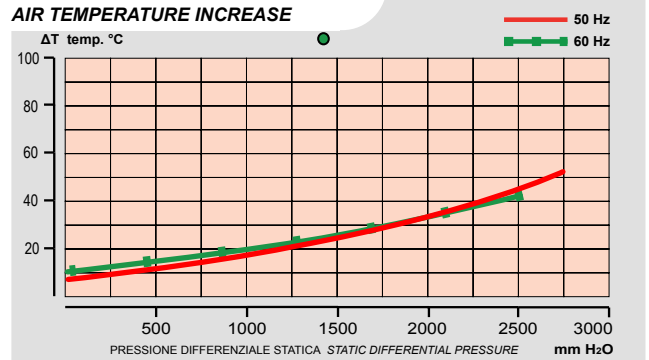

All data is intended as an indication and may be modified without prior notice.  
The vacuum curve is valid for pumping air, with a temperature of 20°C at the inlet flange and with a pressure of 1013 mbar at the discharge port.  
The pressure curve is valid for pumping air, with an average temperature of 20°C and 1013 mbar at the inlet flange.

l/min = m<sup>3</sup>/h · 16,667  
CFM = m<sup>3</sup>/h · 0,588  
mbar = mm H<sub>2</sub>O · 0,098  
PSI = mm H<sub>2</sub>O · 0,00142