

'QUIPTRON' SKIMMER

SKIMMERS FOR IN-GROUND POOLS



Rainbow Pool Products
 PO Box 2388, Mansfield Qld 4122
 Telephone STD 61-7-3849 5385
 Facsimile STD 61-7-3849 5384
 Email: info@rainbowpoolproducts.com.au
 Web: www.rainbowpoolproducts.com.au



Featured Highlights

- Direct replacement for thousands of skimmers sold and installed through Australia.
- One piece body-no glue joints for potential leaks.
- Robust moulded basket locks in with bayonet action.
- Flow-control valve.
- Compliant to AS1926.3 when installed with an auxiliary outlet complying with AS1926.3 (6.1.2b).

The Quiptron Skimmer skims a thinner layer of surface water at a higher velocity, resulting in 300 to 500% more surface skimming and it does it at flow rates as low as 40LPM. Conventional skimmers require flow rates of 100LPM or more. The weir is responsible for the Quiptron Skimmers's efficiency. Its hydrodynamic shape creates a lifting action on the wier, much like an airplane wing. This uplift speeds up the surface flow and eliminates ineffective deep currents.

Ordering Information

Product	Description	Carton Dim. (mm)	Pallet Qty.	Carton Wt. (kg)
Skimmers for In-Ground Pools				
5315000	'Quiptron' Skimmer for Concrete Pools	390x320x480	24	3.6
5315010	'Quiptron' Skimmer + Escutcheon for Fibreglass/Vinyl Liner Pools	390x320x480	24	3.8
5315050	'Quiptron' Skimmer + Extension Throat for Concrete Pools	390x320x480	24	3.8
5315060	'Quiptron' Skimmer + Extension Throat + Escutcheon for Fibreglass/Vinyl Liner Pools	390x320x480	24	4.0
'QUIPTRON' Skimmer Attachments				
5316500	Extension Throat for 'Quiptron' Skimmer	-	-	-
5315500	Extension Lid Ring for 'Quiptron' Skimmer	-	-	-

Dimensions

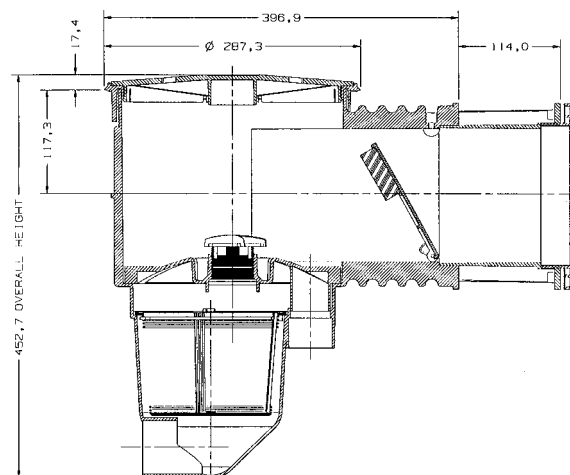
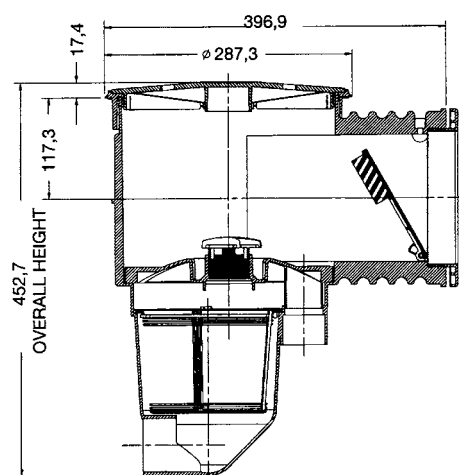

*All dimensions in mm.

See page **180** for replacement parts.